



World's first upright and portable
wrinkle removal machine



INSTRUCTION MANUAL



Distributed by:
Thane Direct Canada, Inc. Toronto ON,
www.thane.ca

Thane Direct UK Ltd. Admail ADM3996 London W1T 1ZU
www.thanedirect.co.uk

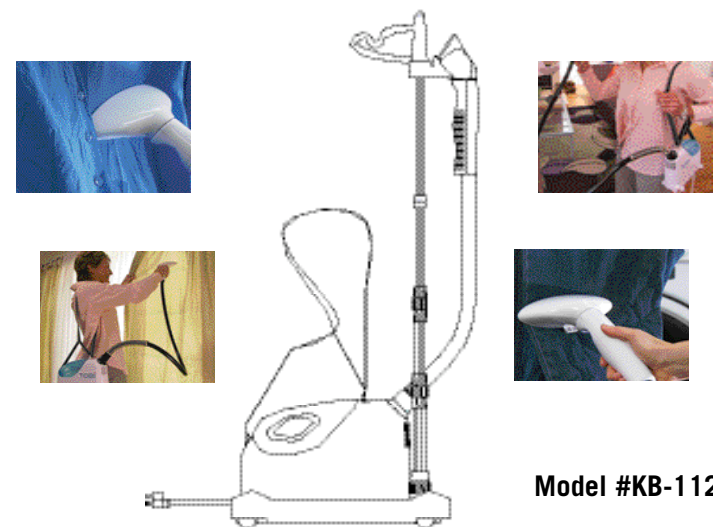

Model #KB-1126

Read this booklet thoroughly before using
and save it for future reference

Table of Contents

❖ IMPORTANT SAFEGUARDS:	02
❖ THE TOBI™ FEATURES	03
❖ SPECIAL INSTRUCTIONS	04
Know your Tobi	04
Before your first use	06
❖ ASSEMBLY INSTRUCTIONS	06
Assembling and mounting the Telescopic Pole	06
Attaching the hose	07
Attachments (Upholstery & Pet/lint hair attachment)	07
❖ OPERATING INSTRUCTIONS	08
❖ HOW TO STEAM	09
❖ QUICK STORAGE	10
❖ CLEANING AND LONG-TERM STORAGE	10
❖ CLEANING MINERAL DEPOSITS	11
❖ TOBI MAINTENANCE	12

IMPORTANT SAFEGUARDS:

When using your TOBi™, basic precautions should always be followed, including the following:

1. Read all instructions prior to usage.
2. To reduce the risk of contact with hot water and steam, always check TOBi™ for steam leaks. Make sure the steam nozzle is placed in its holder prior to switching on and inspecting the base hose, handle and nozzle for leaks.
3. Do not use TOBi™ outdoors.
4. Steam only in an up and down vertical motion (except when steaming bedding directly on bed). Never use steamer in a horizontal position or tilt into a backward position, this may result in water discharge.
5. Never force the plug into an outlet. Check that the main voltage corresponds to the voltage indicated on the rating label, see specifications below:
TUV/UK 220-240V 50/60Hz 1500W with power cord current 15A.
6. Avoid contact with hot parts. Keep hands, hair, and clothing away from hot parts to prevent burns.
7. To protect against fire, from electric shock and injury do not immerse TOBi™ in water or other liquids.
8. Tobi is not a toy. Close supervision is necessary when any appliance is used by or near children.
9. Always disconnect from outlet when not in use and before cleaning. Allow it to cool before putting on or taking off parts, and before cleaning the appliance.
10. Always disconnect Tobi from outlet when filling with water, emptying water tank, and when not in use.
11. Do not operate any appliance with a damaged cord or plug. Stop use immediately if TOBi™ malfunctions, or has been damaged in any manner.
12. The use of accessory attachments that do not come with the TOBi™ may result in fire, electric shock or injury to persons.
13. Do not let cord hang over edge of table or counter, or touch hot surface. The power cord should not be kinked or obstructed in any way.
14. Do not allow cord to touch hot surfaces. Let appliance cool completely before storing.
15. Always keep the steam nozzle elevated above water container. Do not lay hose on the floor.
16. Do not operate TOBi™ without properly filling the water container.
17. Always turn the switch to the "OFF" position before plugging in or unplugging the unit.
18. Never pull the power cord to disconnect it from an outlet. Instead, grasp the plug to remove it from the outlet.
19. Do not use TOBi™ for other than intended use.
20. Never attempt to steam clothing while on body.
21. **SAVE THESE INSTRUCTIONS.**

HOUSEHOLD USE ONLY

The Tobi Features

- ❖ Easy On/Off switch.
- ❖ Easy grip handle.
- ❖ 30 second start up time.
- ❖ 30 minutes continuous steam.
- ❖ Lightweight, flexible hose.
- ❖ Shatterproof water tank.
- ❖ Automatic shut-off. TOBi™ automatically shuts off when water tank is empty.
- ❖ Comfortable, easy-grip handle.
- ❖ Height adjustable hanger pole.
- ❖ Easy-roll casters for mobility.
- ❖ Upholstery attachment.
- ❖ Pet hair attachment.
- ❖ Travel bag - store main unit, hose and carry strap in this bag. The bag is not made for the pole or Tobi's rollable base.

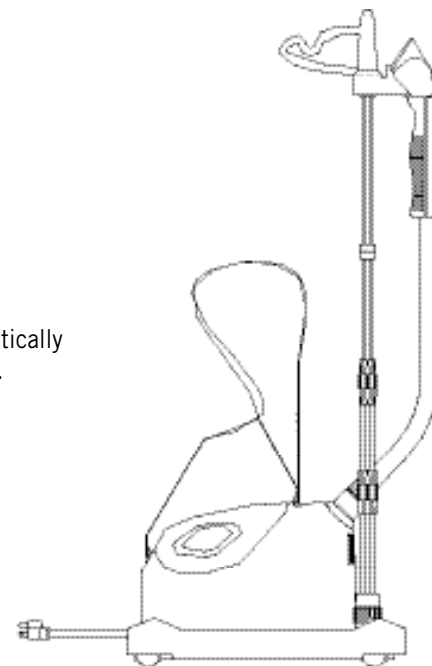

SPECIAL INSTRUCTIONS

1. To reduce the likelihood of a circuit overload, do not operate another high-wattage appliance on the same circuit as Tobi.
2. If an extension cord is absolutely necessary, a 15 amps rated cord should be used. Cords rated for less amperage may overheat. Care should be taken to arrange the cord so that it cannot be inadvertently pulled or tripped over.

Know your TOBi™

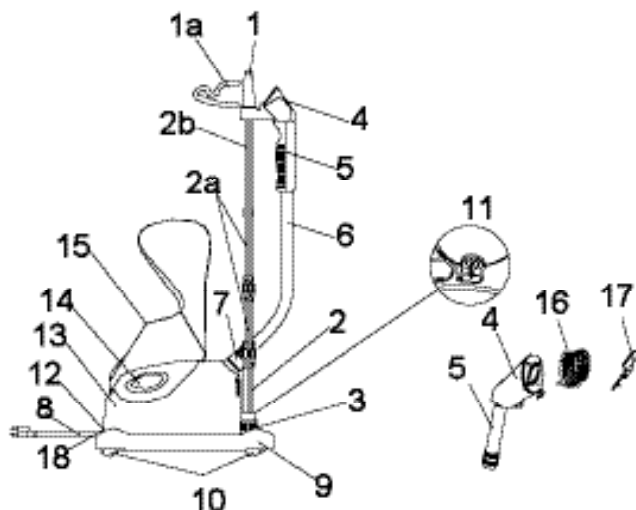

1. **Pole Top** - The Pole Top is comprised of the Clothes Hanger Hook (1a) and Steam Nozzle Holder (1b). The Clothes Hanger Hook allows you to steam garments right on the hanger.
- 1a. The Clothes Hanger Hook allows you to steam clothing right on the hanger. The groove in the Hanger Hook fits any hanger. Lightly click a hanger in the groove to help the hanger stay in place while steaming.

2. **Pole** - The Pole with the Telescopic Pole (2a) with the Pole Extension (2b) / connects the Pole top to the steamer and provides quick, compact storage of the unit. The Telescopic Pole is comprised of Part 2A and Part 2B part (SEE FIG.1).
3. **Pole Base** - The Pole Base ensures a stable mount for the Pole.
4. **Steam Nozzle** - The Steam Nozzle spreads the steam over a wide area providing hot, penetrating steam.
5. **Handle** - The Handle is permanently attached to the Steam Nozzle. Use the handle to safely direct the steam onto the desired fabric.
6. **Steam Hose** - The Hose directs the steam from the Main Unit to the Handle and Steam Nozzle. Never pull, bend or wrap the hose, it will damage the hose and result in steam leak. During the operation, do not touch the Steam Hose. It gets very hot and can burn or scald your skin.
7. **Hose Base** - The Hose Base is a threaded plastic pipe for the attachment of the Hose.
8. **Power Cord** - Connects the Main Unit to the power outlet.
9. **Unit Base** - When operating TOBi™, fix the Main Unit on the rollable base. If you require TOBi™ to be portable, attach the carrying strap and press Release Button (#18) and place Tobi on your shoulder.
10. **Casters** - There are four roll casters, allow for ease of movement.
11. **Drain Switch** - Drain the water in the Main Unit by turning the Drain Switch to the "OPEN" position. Make sure you tighten securely to avoid water leakage.
12. **Lighted Switch** - When plugging the power outlet, turn it to the "ON" position, the light will be illuminated.
13. **Main Unit** - The water in the water tank will flow into the Main Unit.
14. **Water Tank** - Water Tank is removable from the Main Unit. Unscrew valve cap, fill to the max line and place the tank back on to the Main Unit.
15. **Shoulder Strap** - When operating TOBi™ in portable mode, use the Shoulder Strap for easy portability.
16. **Upholstery Attachment** - Upholstery Attachment is suitable for breathing new life into sofa's, cushions, chairs and drapes. Attach to Steam Nozzle.
17. **Lint/Pet-hair remover** - It is suitable for removing lint and stubborn pet hair from your clothes and upholstery while refreshing them at the same time. Attach to Steam Nozzle.
18. **Release Button** - Press the Release Button to take out the Main Unit to make TOBi™ portable.

Before your first use:

1. Remove any packaging and factory labeling from TOBi™.
2. Assemble TOBi™ according to the assembly instruction section, then fill the Water Tank with water at the max level, then operate TOBi™ according to the operation instructions.

Assembly Instructions

I. Assembling and mounting the Telescopic Pole. (SEE FIG.1)

1. Loosen the ridged knob of the pole by turning it counterclockwise. Insert the Telescopic Pole (#2A) into the Pole (#2). Tighten the ridged knob by turning it clockwise.
2. Loosen the ridged knob of the Telescopic Pole (#2A) part by turning it counterclockwise. Insert the Pole Extension (#2B) into the Telescopic Pole (#2A) part. Tighten the ridged knob by turning it clockwise.
3. Screw the Pole Extension (#2B) onto the Telescopic Pole (#2A) by turning the Pole Extension (#2B) clockwise.
4. Place the Pole Top (#1) on top of the Pole Extension (#2B) and turn it clockwise until lock.

NOTE: The Telescopic Pole must be fully extended during operation of the TOBi™ to ensure a free flow of steam through the Hose.

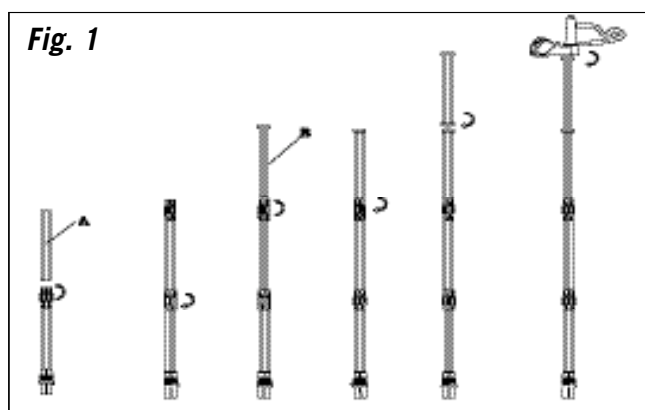

5. Loosen the Pole Base (#3) by turning it counterclockwise.
6. Insert the bottom of the Pole into the Pole Base (SEE FIG. 2) in such a way so that the Clothes Hanger Hook faces the rear of the TOBi™. Pointing the Clothes Hanger Hook towards the rear will ensure the stability of TOBi™ when garments are hanging from the Clothes Hanger Hook.
7. Push the Pole down as far as possible.
8. Tighten the Pole Base by turning the ridged knob clockwise.

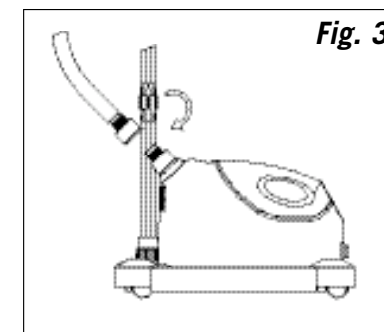
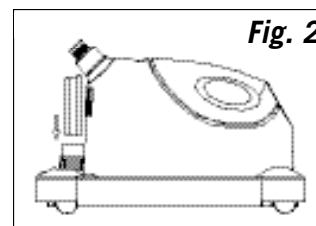

II. Attaching the hose

1. Screw the Hose onto the threaded Hose Base by turning the fitting on the end of the Hose clockwise (SEE FIG.3).
2. Hand-tighten only. Do not over-tighten.
3. Hang the steam Nozzle on the Steam Nozzle Holder.

CAUTION: To prevent steam from causing bodily injury or damage to surface, always hang the Steam Nozzle on the Steam Nozzle Holder when not in use. Do not lay the Hose on the floor as condensation may occur, causing unwanted water droplets in the steam.

CAUTION: Pulling on the Hose with excessive force will damage the Hose, resulting in a steam leak.

III. Attachments (Upholstery & Pet/lint hair attachment)

1. Turn TOBi™ off, and wait until steam no longer emits from the Steam Nozzle.
CAUTION: To avoid burns, do not try to install the attachments while steam is coming from the Steam Nozzle.
2. Align the pegs along the back of the attachments with the holes on the Steam Nozzle.
3. Push as shown in FIGURE 4 until the attachments is firmly in place.

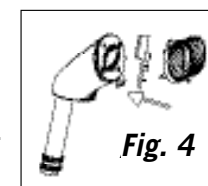

Operating Instructions:

1. Unplug the Power Cord, and turn the Lighted Switch to the "OFF" position.
2. Remove the Water Tank; turn it upside down, and unscrew the Valve Cap (SEE FIG.5)
3. Fill the Water Tank with cool water, and replace the Valve Cap.
4. Place the Water Tank on the Main Unit (SEE FIG.6). You should hear water flowing into the Main Unit for a short time.

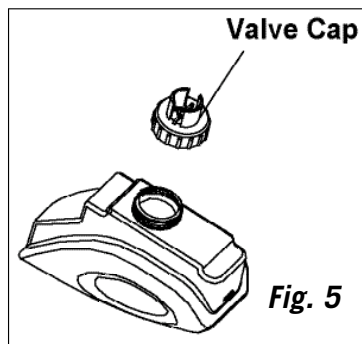

Fig. 5

CAUTION: Do not operate TOBi™ with a dry Water Tank. When operating, if you want to add water, first turn the Lighted Switch to "OFF" position, before removing the Water Tank to avoid burning yourself.

5. Plug TOBi™ into a grounded three-pronged outlet.
Warning: If a grounded three-pronged outlet is not available, a 3-to-2 prong adapter can be used only if the adapter itself is properly grounded.

6. Turn the Lighted Switch to "ON" position, the light will be illuminated.

7. Steam should start flowing from the Steam Nozzle. Wait for steam to heat sufficiently otherwise you will create wet spots. Wait at least 30 seconds.

8. To steam a garment, place item of clothing on the hanger and steam directly on the Hanger Hook.

Caution: Be careful when handling garments on the Clothes Hanger Hook. Pulling on the garment with too much force may cause TOBi™ to tip.

9. Grasp the handle, and place the Steam Nozzle at the top of the garment. Steam will rise along the inside and outside of the fabric, removing wrinkles. Slowly slide the Steam Nozzle vertically, from the top to the bottom of the garment. You may also reverse this motion and steam from the bottom to the top.
Note: Do not allow kinks to form in the hose at any time.

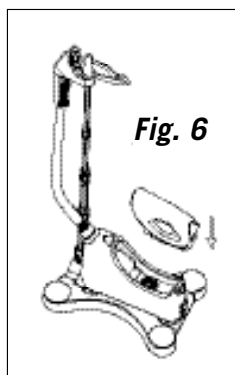

Fig. 6

10. Repeat steps 9 until the fabric is wrinkle free.
11. Curtains and draperies can be steamed while they are hanging. Press the Release Button and use Shoulder Strap to put the Main Unit on the shoulder for these items.

Note:

1. During steaming, make sure that the hose is fully extended to insure a free flow of steam through it.
2. When removing the Main Unit from the Base, always use Shoulder Strap. Assemble the Shoulder Strap on the Main Unit, by inserting the end of the Shoulder Strap into the slot of the Main Unit. To remove the Shoulder Strap press the round bump to release the Shoulder Strap.

12. When finished using TOBi™, turn the Lighted Switch to the "OFF" position.

How to Steam

TOBi™ removes wrinkles from all your clothes five times faster than iron. It works on virtually all fabrics, silk, denim, cotton, polyester and wool. PLEASE REFER TO LABEL ON ITEM OF CLOTHING TO CHECK IF GARMENT CAN BE STEAMED. SOME FABRICS LIKE LEATHER, SUEDE, VELVET MAY NOT BE SUITABLE FOR STEAMING. IF YOU ARE NOT SURE THEN STEAM A SMALL PART OF THE INSIDE OF THE GARMENT TO TEST THAT IT DOES NOT DAMAGE THE FABRIC BEFORE STEAMING THE ENTIRE GARMENT OR FABRIC.

- ❖ Some articles can be steamed better from the underside. This allows the steam to relax the fibers of the material, thus removing the wrinkles.
- ❖ Pants may be easily steamed by holding them by the cuff.
- ❖ When steaming, touch material lightly with Steam Nozzle and move up and down to remove wrinkles. It is important that Steam Nozzle makes contact with the garment and/or fabric.
- ❖ Always steam with hose in upright position so any condensation is free to flow back into the steamer. If steaming in a low position near floor, frequently extend Hose up and out to keep clear.
- ❖ TOBi™ helps to eliminate trips to the drycleaner by helping to reduce odors. It will not remove stains from garments.
- ❖ Convenient hanger/hook mechanism holds both the clothes and steam head securely.

- ❖ Use TOBi™ directly on sheets while on the bed to smooth out and remove wrinkles.
- ❖ Use TOBi™ directly on mattresses and pillow cases to help eliminate dust-mites.
- ❖ Use TOBi™ directly on upholstery to help refresh and breathe new life into sofas and chairs.

Quick Storage

1. Turn the Lighted Switch to "OFF".
2. Unplug the Power Cord.
3. Wrap the Hose around the Telescopic Pole one time.
4. Hang the Steam Nozzle from the Steam Nozzle Holder.
5. Loosen the two ridged knobs on the Telescopic Pole by turning them counterclockwise.
6. Push down on the Pole Top, the Telescopic Pole will collapse to a compact height.
7. Roll TOBi™ to a convenient storage location.

Cleaning and Long-term Storage

We recommend you follow this procedure at least once per month. Use of distilled or de-mineralized water will help to reduce the need for cleaning and prolong the life of TOBi™. However, you can use ordinary tap water as well.

1. Turn the Lighted Switch to "OFF".
2. Unplug TOBi™ from the power outlet.
3. Wait for TOBi™ to cool completely.
4. Disassemble the Hose and the Telescopic Pole, and set them aside.
5. Carry the Main Unit to a sink or tub.
6. Remove and drain the Water Tank, rinse the Water Tank with fresh water, and drain completely.
7. Drain the steamer by unscrewing the drain switch out and empty the contents into the sink or tub. Tilt the unit towards the drain plug to facilitate removal of the water. Then screw on the switch.

8. Flush the Main Unit by filling the Water Tank with fresh water and draining completely.
9. Assemble the Telescopic Pole and Hose.
10. Follow steps 3-7 of the quick storage section.

Cleaning Mineral Deposits

One common problem with all steamers is mineral deposit caused by a high mineral content in many municipal water supplies. Mineral residue inside of the internal pipes and heater can cause intermittent steaming or, in some cases, no steaming at all.

Note: To reduce or eliminate the occurrence of mineral deposit, we recommend the use of de-mineralized or distilled water in the Main Unit. However regular tap water can also be used.

The section below can be used to reduce mineral deposit. If not using de-mineralized or distilled water, we recommend you follow this procedure monthly.

1. Turn TOBi™ "OFF" and unplug the power cord.
2. Remove the Hose and Pole from the Main Unit.
3. Mix a solution of 50% vinegar and 50% water. Two cups of this solution will be sufficient.
4. Slowly pour the solution into the Water Tank and replace the Valve Cap.
5. Place the Water Tank on the Main Unit. You should hear water flowing into the Main Unit for a short time.
6. Allow it to stand for 40 minutes.
7. Drain the solution out from the Water Tank into a sink or tub.
8. Pour clean water in the Main Unit and drain. Repeat this step until the vinegar odor dissipates.
9. Reassemble Tobi and operate normally.

TOBi™ Maintenance

Clean and rinse your Tobi regularly:

All steamers need to be cleaned and rinsed on occasion to remove mineral deposits. If steam from the TOBi™ becomes intermitted or stops altogether please refer to the section on cleaning of mineral deposits.

Never Use additives:

Additives such as salt, perfumes and dyes should never be added to the Water Tank. These substances will corrode or clog internal parts.

Steam in a vertical, upright position:

Do not use your TOBi™ in horizontal position like an iron. Steam in a vertical up and down motion. This will allow the condensation in the hose to flow back into the Main Unit.

Do not pull Tobi by the power cord:

Pulling TOBi™ by the power cord may cause the internal wiring to become loose.

Never use your foot to turn Tobi ON/OFF:

Damage may occur to the power switch should you turn the unit off using excess pressure with your foot.

Storing Tobi:

Before storing TOBi™ for an extended period (30 days or more), empty all water from the Main Unit. Water becomes stale with time and may clog internal parts.